

OLT Congo offers gigabit and 10-gigabit optical modules



Overview

Our SDX 6000 Series of software-defined optical line terminals (OLTs) consists of open and disaggregated access devices that support a broad range of PON standards, including 10G Combo PON, XGS-PON, GPON, and 10G-EPON. These devices are built using modern design principles. Upgrade to gigabit symmetric services today and prepare for tomorrow's technologies. HiOSO HA7304G-JT GPON OLT, which provides 4 GPON ports, 4 GE/10GE SFP/SFP+ (10GE) optical uplink ports, SFP uplink ports support optical and copper sfp modules, and 4 GE Lan uplink ports. Fiber-to-the-home (FTTH) network operators benefit from deploying OLT solutions that span dense urban, suburban, and rural. service providers a cost-effective fiber optic delivery system for Triple Play Services (data, voice, IPTV/VoD) with speeds of up to 2. The U Fiber network is intelligently managed using the included UNMSTM (Ubiquiti Network Management System) controller. The Nokia Lightspan DF is a family of optical line terminals (OLT) that gives you new flexibility in your fiber deployments and. A gigabit passive optical network (G-PON) comprises optical line terminals (OLTs) and optical network units (ONUs), and Murata's lineup of products for use in OLTs is introduced here.

OLT Congo offers gigabit and 10-gigabit optical modules



It uses 10G XGSPON optics to enable 10G PON solutions at a fraction of the cost of fixed-format OLT chassis and stand-alone “pizza box” OLT. This 10G OLT plugs into the Corning SDDP via available ...

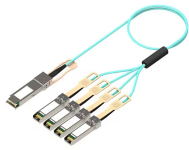

A gigabit passive optical network (G-PON) comprises optical line terminals (OLTs) and optical network units (ONUs), and Murata's lineup of products for use in OLTs is introduced here.



A gigabit passive optical network (G-PON) comprises optical line terminals (OLTs) and optical network units (ONUs), and Murata's lineup of products for use in ...



Our SDX 6000 Series of software-defined optical line terminals (OLTs) consists of open and disaggregated access devices that support a broad range of PON standards, including 10G Combo ...



The HA7302GD adopts a MINI 2PORT design, supporting two GPON optical ports, two 10 Gigabit SFP optical ports, and four Gigabit adaptive RJ45 electrical ports for uplink.



You can deploy Fin as an OLT or Remote OLT (R-OLT) for 10G or 10G PON from your central office, hub or from various Harmonic DAA nodes to accelerate to 10G with minimal modifications to your ...

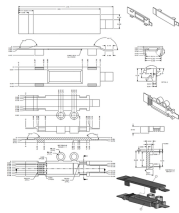

Zyxel's GPON OLTs offer advanced signal processing for dense deployments. Upgrade to gigabit symmetric services today and prepare for tomorrow's ...



The OLT acts as the provider-side termination device, aggregating traffic from multiple ONTs (Optical Network Terminals) located at customer premises. SFP-based OLTs are commonly ...

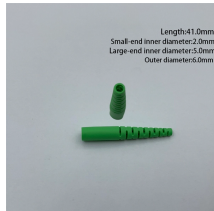

The Nokia Lightspan DF is a family of optical line terminals (OLT) that gives you new flexibility in your fiber deployments and helps optimize the business case.



Zyxel's GPON OLTs offer advanced signal processing for dense deployments. Upgrade to gigabit symmetric services today and prepare for tomorrow's technologies.



The U Fiber OLT offers eight GPON ports and supports up to 1024 concurrent clients with physical links of up to 20 km in distance. Two SFP+ ports provide 10G of uplink connectivity.

Contact Us

For more information, pricing, or custom solutions, please contact us:

Website: <https://www.indzawo.co.za>

Email: sales@indzawo.co.za

Phone: +27 71 296 8473

Address: 22 Quantum Street, Midrand, 1685, Gauteng, South Africa

This document is for informational purposes only. Specifications subject to change without notice.

