

Model of Fiber Optic Cable Splice Box

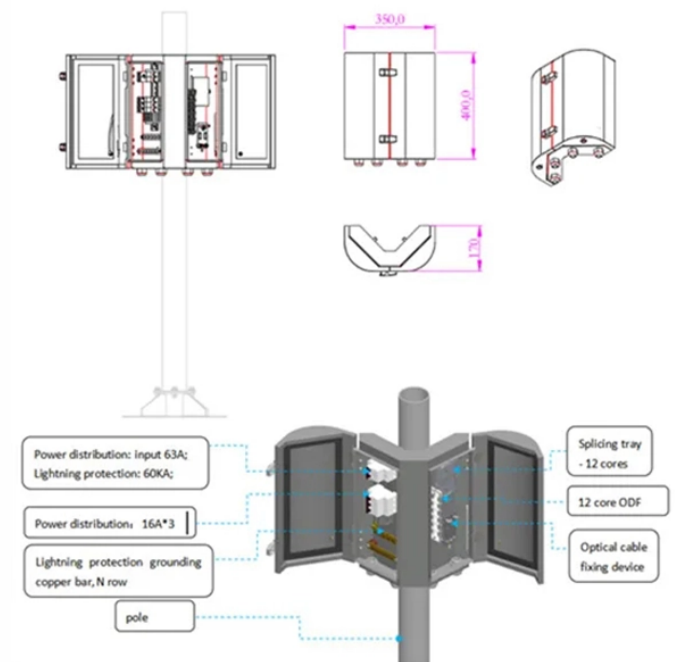

Model of Fiber Optic Cable Splice Box



Explore reliable optical fiber splice closures for network deployment. Our closures prioritize reliability, installability, and flexibility.



Under accessories you will find splitter and cable management frames. The cable management frames are available in 3 different sizes in lacquered aluminum that are adapted to FOSC splice boxes.



FIBER SPLICE BOX The FSB series of indoor wall mount enclosures are designed for centralized splice-only applications. These boxes are well suited as optical cable splice collection points for DAS ...



Splice boxes ensure continuously reliable real-time data transmission. With their compact and uniform design, the splice boxes for both the DIN rail and 19" mounting provide ample interior space for the ...



AFL offers robust fiber optic splice closures—including Apex® high-density and LightGuard® weathertight and sealed models—for above-ground, aerial, and buried applications.



Suitable for all cable types but optimized for Ribbon cables, the 2178 closure will support any application. The 2178 family includes seven distinct models - XSB, XLB, S, SL, LS, LL, and XL in ...



The FIMP-M splice box, compactly sized at 115 x 61 x 113 mm, offers a versatile and efficient solution for fiber optic connectivity. This splice box is equipped to accommodate a range of couplings, providing ...



Fiber Optic Splice Boxes: Selection Criteria, and Maintenance Best Practices Introduction In our hyper-connected world, the seamless flow of data is powered by a vast, underlying infrastructure of fiber ...



Add to cart Fiber Optic Junction Box, 2 in 2 Out Splice Box, Mini Small Square Type 12 Core Outdoor Waterproof Protection Box Add to cart FTTH Fiber Optic Waterproof Box, IP67 Rated Outdoor/Indoor ...

Contact Us

For more information, pricing, or custom solutions, please contact us:

Website: <https://www.indzawo.co.za>

Email: sales@indzawo.co.za

Phone: +27 71 296 8473

Address: 22 Quantum Street, Midrand, 1685, Gauteng, South Africa

This document is for informational purposes only. Specifications subject to change without notice.

