

## Is CE6851 a fiber optic switch



### Overview

The CE6851-48S6Q-HI-F is a Huawei network switch with 48 SFP+ ports, 6 QSFP+ ports, and no power supply. It has a switching capacity of 1. Support for Fiber Channel over Ethernet (FCoE) allows a single network to carry storage, data, and computing services, reducing network constructio the appearance of CE6851-48S6Q This document provides an overall description of the CE5800&6800&7800&8800 series switches hardware that versions earlier than V200R020C00, helping you obtain detailed information about each chassis, power module, fan module, card, cable, and pluggable modules for ports. This document provides an. t-side Exha construct Huawei CE6800 Series Switch CE6851-48S6Q-HI support 48-Port 10G SFP+, 6-Port 40GE QSFP+. When the altitude is 1800-5000 m (5096-16404 ft. Support for Fiber Channel over Ethernet (FCoE) allows.

## Is CE6851 a fiber optic switch



SFP-GE-LX-SM1310 Optical Transceiver, eSFP, GE, Single-mode Module(1310nm, 10km, LC)



Support for Fiber Channel over Ethernet (FCoE) allows a single network to carry storage, data, and computing services, reducing network construction and maintenance costs The industry.



This document provides an overall description of the CE5800& 6800& 7800& 8800 series switches hardware that versions earlier than V200R020C00, helping you obtain detailed information about ...



CE6851-48S6Q-HI is HW CE6851-48S6Q-HI Switch (48-Port 10G SFP+,6-Port 40GE QSFP+,2\*FAN Box,Port-side Intake,Without Power Module). Support for Fiber Channel over Ethernet (FCoE) allows ...



HuaTelecom provides brand new original sealed Huawei CE6851-48S6Q-HI Switch, with a maximum warranty of 60 months, 3-5 days global delivery, 24-hour technical support



Support for Fiber Channel over Ethernet (FCoE) allows a single network to carry storage, data, and computing services, reducing network construction and maintenance costs The industry.

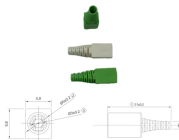

The CE6851-48S6Q-HI-F is a Huawei network switch with 48 SFP+ ports, 6 QSFP+ ports, and no power supply. It has a switching capacity of 1.44 Tbit/s and supports features like FCoE, IPv6, QoS, ACLs, ...



High-performance Huawei CE6851-48S6Q-HI-B switch with 48x10G SFP+ & 6x40G QSFP+ ports, 1.44Tbps capacity, FCoE support, and 1-year warranty.

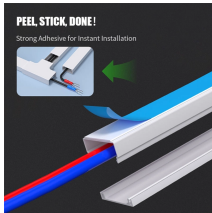

The document provides details about the CE6851-48S6Q-HI-F switch, including its specifications, ports, modules, and comparison to a similar model. It has 48 10G SFP+ ports, 6 40G QSFP+ ports, a ...



The Modules ... Compare to Similar Items ... Get More Information Do you have any question about the CE6851-48S6Q-HI-F (02350JAP)? Contact us now via [info@hi-network](mailto:info@hi-network) .



CloudEngine 6851-48S6Q- HI is a next-generation 10G Ethernet switch with 48-Port 10G SFP+, 6-Port 40GE QSFP+. It is designed for data centers and high-end campus networks, providing high ...



CloudEngine 6851-48S6Q- HI is a next-generation 10G Ethernet switch with 48-Port 10G SFP+, 6-Port 40GE QSFP+. It is designed for data centers and high-end ...

## Contact Us

For more information, pricing, or custom solutions, please contact us:

Website: <https://www.indzawo.co.za>

Email: [sales@indzawo.co.za](mailto:sales@indzawo.co.za)

Phone: +27 71 296 8473

Address: 22 Quantum Street, Midrand, 1685, Gauteng, South Africa

This document is for informational purposes only. Specifications subject to change without notice.

