

# Indzawo Optic Connect

## Does a primary distribution box necessarily need to be housed

Component Diagram

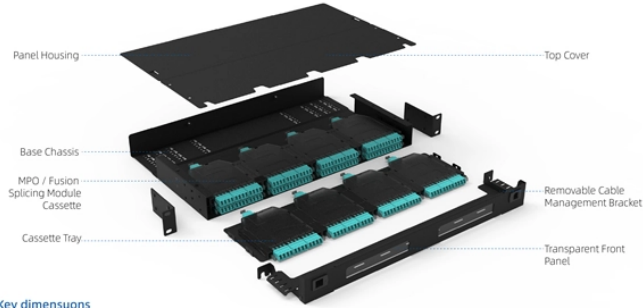

Key dimensions

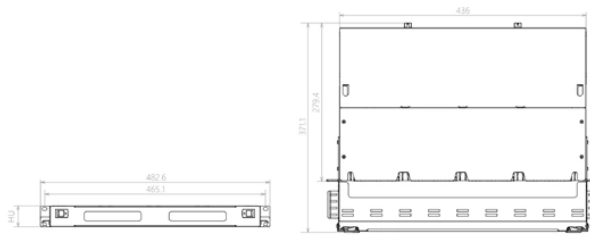

## Does a primary distribution box necessarily need to be housed



Choosing the right distribution box isn't one-size-fits-all. You need to consider where it will be used, how much power it needs to handle, and how well it's built to last.



At the heart of this network are panelboards and distribution panels, typically housed within robust electrical cabinets. These components are responsible for dividing electrical power into ...



What's the difference between a distribution box and a sub-panel? A distribution box typically refers to the main electrical panel that receives power from the utility service. A sub-panel is ...



What is the difference between a load center and a panelboard? A load center provides similar functionality in a power distribution system as compared to a panelboard. As far as UL and the NEC ...



Can I install a distribution box myself, or should I hire a professional? It is recommended to seek the services of a licensed electrician to prevent improper installation.



North American distribution boards are generally housed in sheet metal enclosures, with the circuit breakers positioned in two columns operable from the front.



The primary role of the power distribution box is to provide a safe and organized way to manage electrical circuits. It acts as a protective enclosure that houses several key components, ...



What are the key considerations for outdoor vs. indoor load centers? Outdoor load centers need to be weatherproof and rated for outdoor use (NEMA 3R), while indoor load centers (rated NEMA 1) are ...



The main disconnect is housed either in the distribution panel (below) or in its own separate box. This depends in part on the location of the distribution panel.



It's important to keep your distribution box in good working condition to ensure the safety and efficiency of your electrical system. Here are a few tips for maintaining your box:

## Contact Us

For more information, pricing, or custom solutions, please contact us:

Website: <https://www.indzawo.co.za>

Email: [sales@indzawo.co.za](mailto:sales@indzawo.co.za)

Phone: +27 71 296 8473

Address: 22 Quantum Street, Midrand, 1685, Gauteng, South Africa

This document is for informational purposes only. Specifications subject to change without notice.

