

Customization Process for Energy-Saving Network Terminal Boxes in Industrial Parks



Overview

This article will detail the practical strategies for optimizing the layout of cable distribution boxes. This article will detail the practical strategies for optimizing the layout of cable distribution boxes. At E-Abel, we provide custom electrical distribution boxes designed to meet the unique needs of industrial, commercial, and residential projects. Different applications require unique configurations: Industrial Plants: High-voltage distribution panels with robust enclosures, corrosion resistance. The design and manufacturing of industrial power enclosures—including floor-standing enclosures, wall-mounted enclosures, terminal boxes, human-machine interface (HMI) enclosures, and supporting systems like thermal and cable management—play a pivotal role in ensuring the efficiency, reliability. Its automated assembly lines involve a network of robotic arms, PLCs, sensors, and distributed control systems — all of which rely on robust, flexible, and easy-to-integrate terminal junction boxes. To meet the stringent operational standards of BYD's EV assembly process, Saipwell was selected as a. Safely conduct, connect and distribute

energy in hazardous areas with R. Regardless of the size and nature of your project and requirement for terminal boxes, the 8150 series is perfect for all industries, anywhere in the world. Our capacity and expertise ensures that we can. Our VX SE unibody enclosure offers maximum space-saving capabilities through a wide range of dimensions with widths up to 1800 mm to replace up to three baying enclosures, and depths down to 300 mm for confined production applications. Its layout directly affects the efficiency of the.

Customization Process for Energy-Saving Network Terminal Boxes in

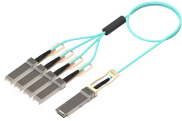

In order to cater to all industry applications, we have a wide range of terminal as well as junction boxes. We offer bespoke, custom-made boxes and box combinations, as well as standard products.

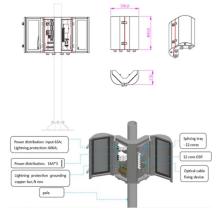

To meet the stringent operational standards of BYD's EV assembly process, Saipwell was selected as a solution provider for custom-designed terminal junction boxes, enabling seamless ...



The guidelines are relevant to both existing and new industrial parks in various international contexts, with a focus on the needs and challenges developing countries and middle-income economies face.



Customization options for electrical enclosures encompass several critical factors, including material selection, structural design, environmental protection, functional add-ons, and surface finishes.



Rittal's network of U.S.-based modification and distribution centers provides coast-to-coast coverage to help ensure your panels and industrial enclosures go from the modification center floor to your door ...



Optimize your cable distribution box layout for safety and efficiency. Learn industrial best practices using Chuanli's IEC-standard outdoor and custom boxes.



Industrial enclosures are at the heart of power and automation systems. By prioritizing quality, innovation, and customer needs, manufacturers ...



Selected high-quality electrical components and standardized wiring processes ensure good anti-interference and load-bearing capabilities for long-term stable operation in complex industrial ...

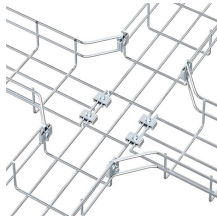

Discover how E-Abel customizes electrical distribution boxes to meet unique requirements for industrial, commercial, and residential applications. Learn about our design, ...



Industrial parks face the problem of diverse forms of terminal energy consumption and single energy supply in the development process at present. We need to pro



Industrial enclosures are at the heart of power and automation systems. By prioritizing quality, innovation, and customer needs, manufacturers can not only meet but exceed global standards.

Contact Us

For more information, pricing, or custom solutions, please contact us:

Website: <https://www.indzawo.co.za>

Email: sales@indzawo.co.za

Phone: +27 71 296 8473

Address: 22 Quantum Street, Midrand, 1685, Gauteng, South Africa

This document is for informational purposes only. Specifications subject to change without notice.

