

Aw distribution box inspection batch

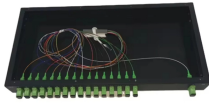

Aw distribution box inspection batch



This type of plan allows 100% control and repair of defective parts (rectifying inspection) during production. This avoids many additional non-value-added ...



Today, we'll break down exactly what separates the best from the rest. Forget cookie-cutter checklists - we're talking about the real, practical inspection points that determine whether a distribution box will ...



The document provides a 16 item checklist for inspecting a main distribution board or panel board.



The document provides a 16 item checklist for inspecting a main ...



F- 502 Distribution of DD FORM 250 AND DD FORM 250C. (a) The contractor is responsible for distributing the DD Form 250, Material Inspection and Receiving Report (MIRR) including mailing ...



Inspect for any physical damage to the enclosure. Ensure that all labels and warning signs are legible. Examine for any signs of overheating or arcing. Verify that the box is securely mounted and that ...

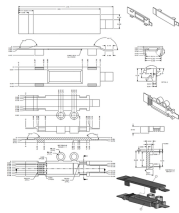

Electrical Distribution Board Inspection Form (1)
This document is an electrical distribution board inspection form used to inspect equipment being brought onto a work site.



The document is an electrical distribution board inspection checklist used by Elite Road Supplies Company-LLC to inspect distribution boards and ensure they meet safety standards.



Regularly inspect Low Voltage Distribution Boxes every three months to catch problems early and avoid costly repairs. Always clean the boxes using safe methods. Turn off power, use dry ...



The term lot or batch shall mean "inspection lot" or "inspection batch", i.e., a collection of units of product from which a sample is to be drawn and inspected and may differ from a collection of units ...



The following duties apply to both continuous and periodic batch plant inspection and shall be performed and documented on a daily basis. The batch plant inspector shall perform all duties outlined in ...



DB Inspection Checklist Overview The document outlines a comprehensive checklist for inspecting a Distribution Board (DB), ensuring it is clean, secure, and compliant with safety regulations.



The document is an inspection checklist for an Electrical Distribution Board (DB) related to the Makeup Water System & Ash Disposal project for NTPC. It outlines various criteria that need to be assessed, ...

Contact Us

For more information, pricing, or custom solutions, please contact us:

Website: <https://www.indzawo.co.za>

Email: sales@indzawo.co.za

Phone: +27 71 296 8473

Address: 22 Quantum Street, Midrand, 1685, Gauteng, South Africa

This document is for informational purposes only. Specifications subject to change without notice.

